

AUDIO & VISUAL SYSTEM COMPONENTS

6708Z-01

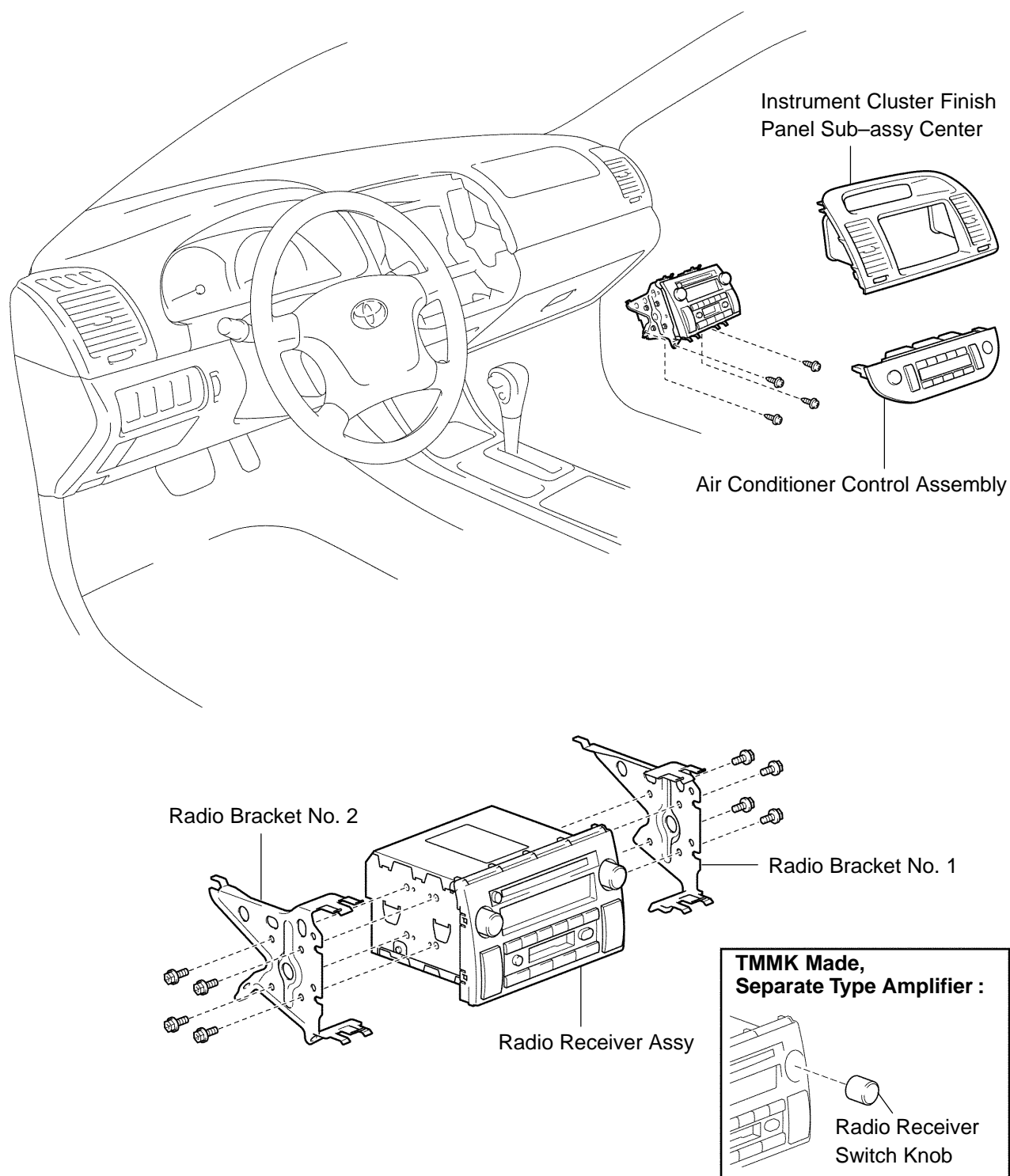

P

I31485

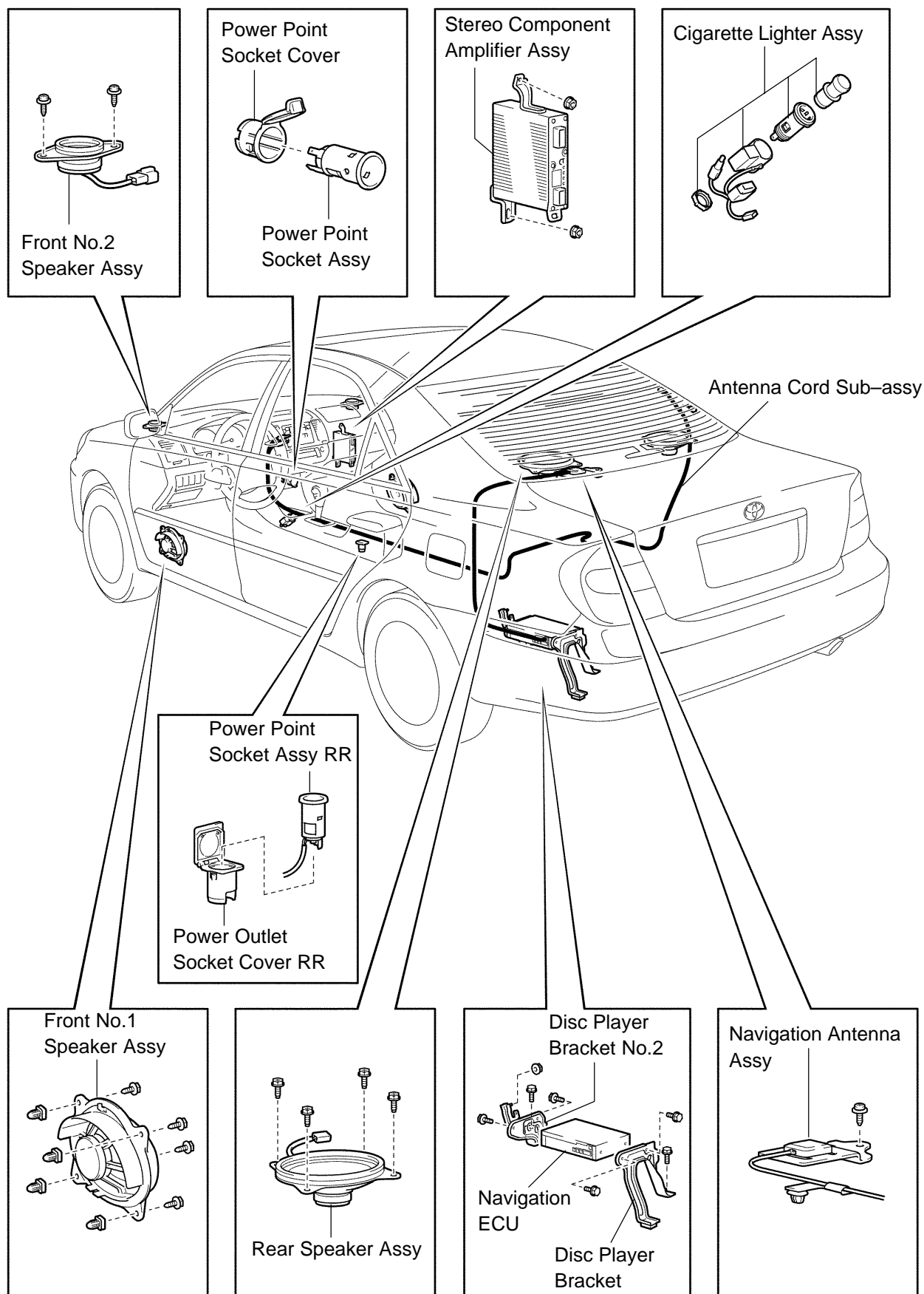

RADIO RECEIVER ASSY REPLACEMENT

6708W-01

HINT:

COMPONENTS: See page 67-1

1. REMOVE AIR CONDITIONER CONTROL ASSEMBLY(See page 71-12)
2. REMOVE INSTRUMENT CLUSTER FINISH PANEL SUB-ASSY CENTER(See page 71-12)

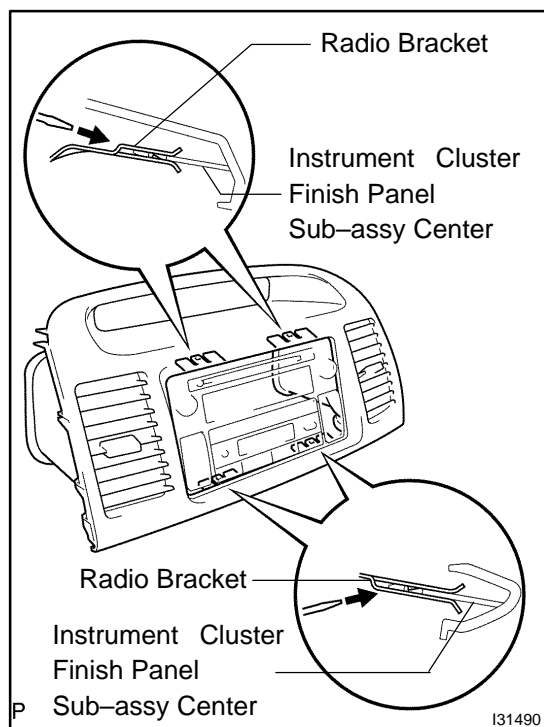

3. REMOVE RADIO RECEIVER ASSY

- (a) Insert a screwdriver at indicated point and remove the radio receiver assy from instrument cluster finish panel sub-assy center.

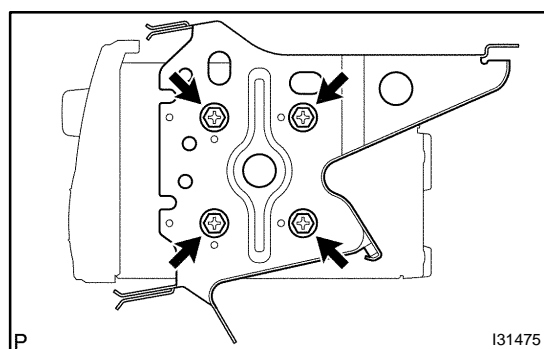

4. REMOVE RADIO BRACKET NO.1

- (a) Remove the 4 screws and radio bracket No.1.

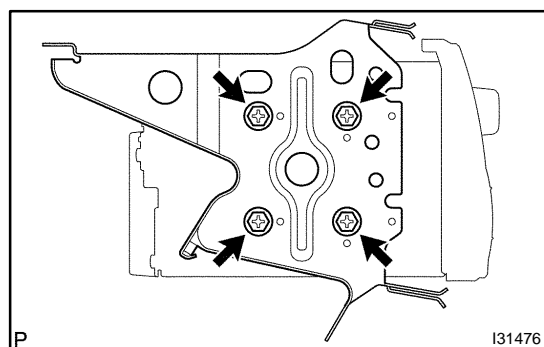

5. REMOVE RADIO BRACKET NO.2

- (a) Remove the 4 screws and radio bracket No.2.

NAVIGATION RECEIVER ASSY REPLACEMENT

6708X-01

HINT:

COMPONENTS: See page 67-1

1. REMOVE AIR CONDITIONER CONTROL ASSEMBLY(See page 71-12)
2. REMOVE INSTRUMENT CLUSTER FINISH PANEL SUB-ASSY CENTER(See page 71-12)

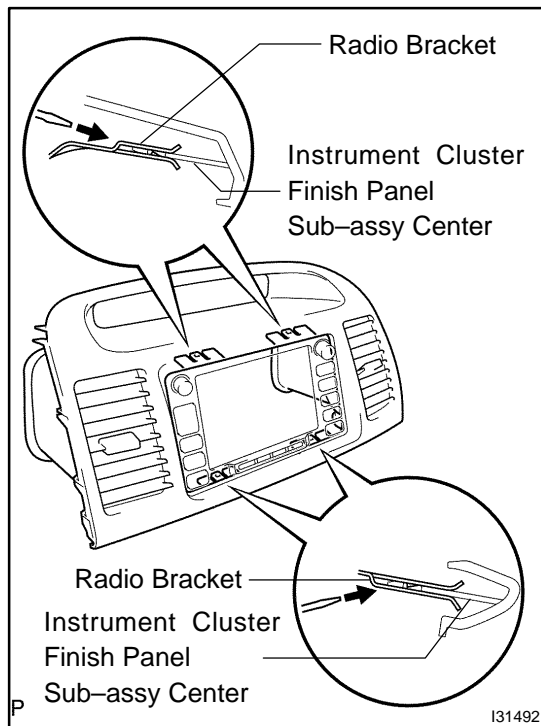

3. REMOVE NAVIGATION RECEIVER ASSY

- (a) Insert a screwdriver at indicated point and remove the navigation receiver assy from instrument cluster finish panel sub-assy.

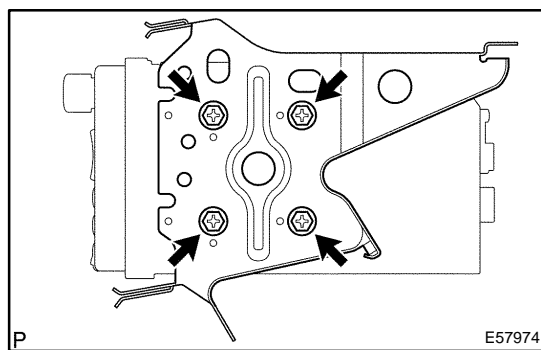

4. REMOVE RADIO RECEIVER BRACKET NO.1

- (a) Remove the 4 screws and radio receiver bracket No1.

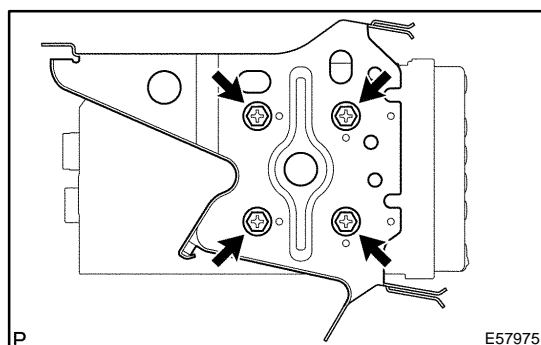

5. REMOVE RADIO RECEIVER BRACKET NO.1

- (a) Remove the 4 screws and radio receiver bracket No.1.

FRONT NO.1 SPEAKER ASSY REPLACEMENT

67093-02

HINT:

COMPONENTS: See page 67-1

1. REMOVE POWER WINDOW REGULATOR MASTER SWITCH ASSY(See page 75-8)
2. REMOVE FRONT DOOR LOWER FRAME BRACKET GARNISH LH(See page 75-8)
3. REMOVE FRONT DOOR INSIDE HANDLE BEZEL PLUG LH(See page 75-8)
4. REMOVE FRONT DOOR TRIM BOARD SUB-ASSY LH(See page 75-8)

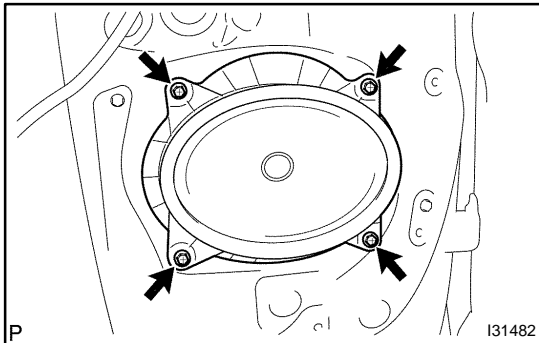

5. REMOVE FRONT NO.1 SPEAKER ASSY
 - (a) Disconnect the connector.
 - (b) Remove the 4 screws and front No.1 speaker assy.

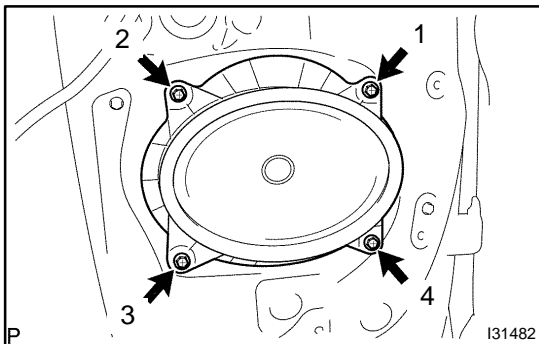

6. INSTALL FRONT NO.1 SPEAKER ASSY
 - (a) Install the front No.1 speaker assy with the 4 screws.**NOTICE:**
Install them in the order shown in the illustration.
 - (b) Connect the connector.

FRONT NO.2 SPEAKER ASSY REPLACEMENT

6708Y-02

HINT:

COMPONENTS: See page 67-1

1. REMOVE INSTRUMENT PANEL SPEAKER PANEL SUB-ASSY NO.2(See page 71-12)

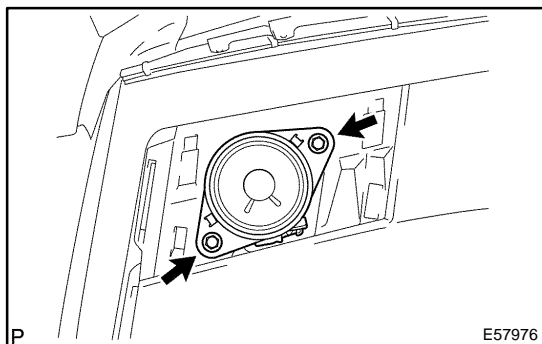

2. REMOVE FRONT NO.2 SPEAKER ASSY

- (a) Remove the 2 bolts.
- (b) Disconnect the connector and remove the front No.2 speaker assy.

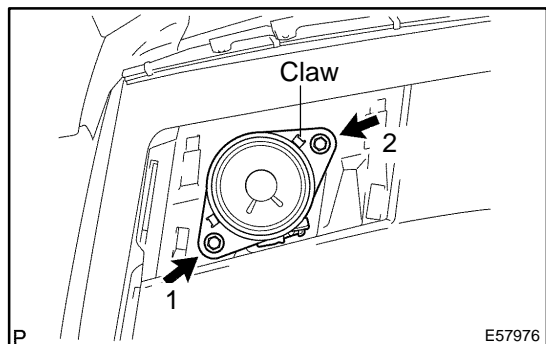

3. INSTALL FRONT NO.2 SPEAKER ASSY

- (a) Connect the connector.
- (b) Align a claw with the notch of the instrument panel safety pad with 2 bolts, and install the front No.2 speaker assy.

NOTICE:

Install them in the order shown in the illustration.

REAR SPEAKER ASSY REPLACEMENT

67091-01

HINT:

COMPONENTS: See page 67-1

1. REMOVE REAR SEAT CUSHION ASSY(See page 72-34 or 72-38)
2. REMOVE REAR SEAT BACK ASSY RH(See page 72-34 or 72-38)
3. REMOVE REAR SEAT BACK ASSY LH(See page 72-34 or 72-38)
4. REMOVE REAR SIDE SEAT BACK ASSY RH(TMC MADE)
(See page 72-34)
5. REMOVE REAR SIDE SEAT BACK ASSY LH(TMC MADE)
(See page 72-34)
6. REMOVE REAR SIDE SEAT BACK ASSY RH(TMMK MADE)
(See page 72-38)
7. REMOVE REAR SIDE SEAT BACK ASSY LH(TMMK MADE)
(See page 72-38)
8. REMOVE ROOF SIDE GARNISH INNER RH(W/O CURTAIN SHIELD AIR BAG)
(See page 76-20)
9. REMOVE ROOF SIDE GARNISH INNER LH(W/O CURTAIN SHIELD AIR BAG)
(See page 76-20)
10. REMOVE ROOF SIDE GARNISH INNER RH(W/ CURTAIN SHIELD AIR BAG)
(See page 76-20)
11. REMOVE ROOF SIDE GARNISH INNER LH(W/ CURTAIN SHIELD AIR BAG)
(See page 76-20)
12. REMOVE REAR SEAT SHOULDER BELT COVER RH
(See page 61-14 or 61-17)
13. REMOVE ROOM PARTITION BOARD ASSY(TMMK MADE)
(See page 61-17)

14. REMOVE PACKAGE TRAY TRIM PANEL ASSY(TMC MADE)

- (a) Pull the package tray trim panel assy upward to disengage 2 clips.
- (b) Put the bezel and anchor part of the seat belt through the slit part.
- (c) Pull it as shown in the illustration to disengage 5 claws.
- (d) Disconnect the connector and remove the package tray trim panel assy.

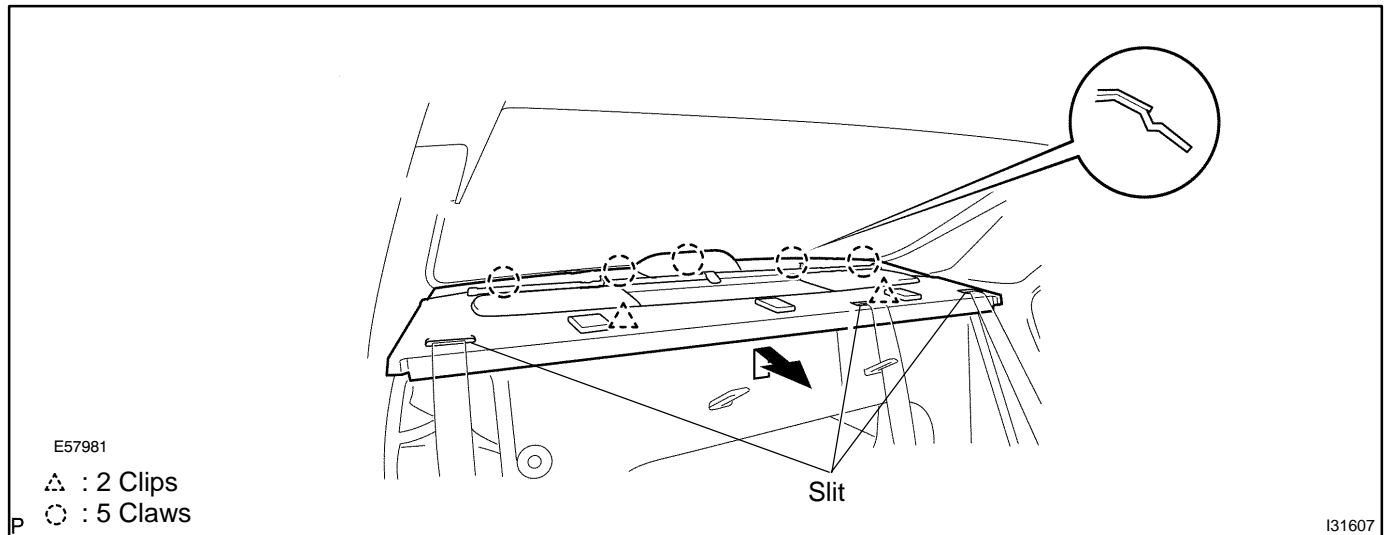
**15. REMOVE PACKAGE TRAY TRIM PANEL ASSY(TMMK MADE)**

(See page 61-17)

16. REMOVE REAR SEAT 3 POINT TYPE BELT ASSY OUTER(TMC MADE)

(See page 61-14)

17. REMOVE REAR SEAT INNER W/CENTER BELT ASSY RH(TMC MADE)

(See page 61-14)

18. REMOVE REAR SEAT INNER W/CENTER BELT ASSY LH(TMC MADE)

(See page 61-14)

19. REMOVE REAR SEAT 3 POINT TYPE BELT ASSY OUTER(TMMK MADE)

(See page 61-17)

20. REMOVE REAR SEAT INNER W/CENTER BELT ASSY RH(TMMK MADE)

(See page 61-17)

21. REMOVE REAR SEAT INNER W/CENTER BELT ASSY LH(TMMK MADE)

(See page 61-17)

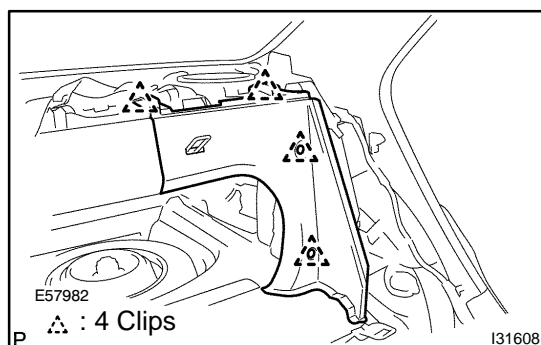
**22. REMOVE ROOM PARTITION BOARD LH(TMC MADE)**

- (a) Disengage 4 clips and remove the room partition board LH.

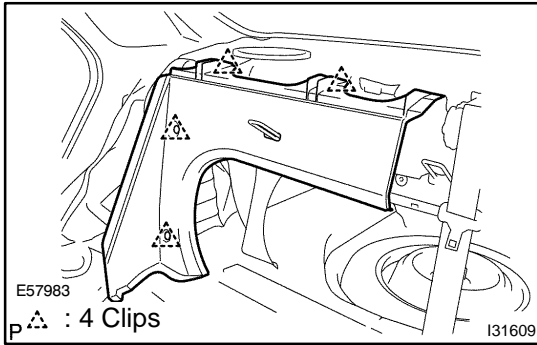
**23. REMOVE ROOM PARTITION BOARD RH(TMC MADE)**

- (a) Disengage 4 clips and remove the room partition board RH.

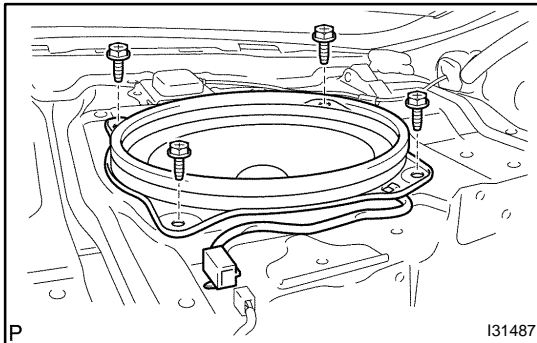
**24. REMOVE REAR SPEAKER ASSY**

- (a) Disconnect the connector.
- (b) Remove the 4 screws and rear speaker assy.

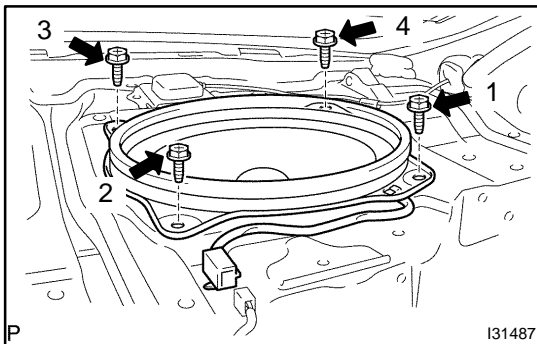
**25. INSTALL REAR SPEAKER ASSY**

- (a) Install the rear speaker assy with the 4 screws.

NOTICE:

Install them in the order shown in the illustration.

- (b) Connect the connector.

26. INSTALL REAR SEAT INNER W/CENTER BELT ASSY RH(TMC MADE)

(See page 61-14)

27. INSTALL REAR SEAT 3 POINT TYPE BELT ASSY OUTER(TMC MADE)

(See page 61-14)

28. INSTALL REAR SEAT INNER W/CENTER BELT ASSY LH(TMC MADE)

(See page 61-14)

29. INSTALL REAR SEAT INNER W/CENTER BELT ASSY RH(TMMK MADE)

(See page 61-17)

30. INSTALL REAR SEAT 3 POINT TYPE BELT ASSY OUTER(TMMK MADE)

(See page 61-17)

31. INSTALL REAR SEAT INNER W/CENTER BELT ASSY LH(TMMK MADE)

(See page 61-17)

32. INSTALL REAR SIDE SEAT BACK ASSY LH(TMC MADE)

(See page 72-34)

33. INSTALL REAR SIDE SEAT BACK ASSY RH(TMC MADE)

(See page 72-34)

34. INSTALL REAR SIDE SEAT BACK ASSY LH(TMMK MADE)

(See page 72-38)

35. INSTALL REAR SIDE SEAT BACK ASSY RH(TMMK MADE)

(See page 72-38)

- 36. INSTALL REAR SEAT BACK ASSY RH(See page [72-34](#) or [72-38](#))
- 37. INSTALL REAR SEAT BACK ASSY LH(See page [72-34](#) or [72-38](#))

STEREO COMPONENT AMPLIFIER ASSY REPLACEMENT

67092-01

HINT:

COMPONENTS: See page 67-1

1. REMOVE FRONT DOOR SCUFF PLATE RH
(See page 71-12)
2. REMOVE COWL SIDE TRIM SUB-ASSY RH
(See page 71-12)
3. REMOVE INSTRUMENT PANEL UNDER COVER SUB-ASSY NO.1
(See page 71-12)
4. REMOVE GLOVE COMPARTMENT DOOR PAD
(See page 71-12)
5. REMOVE INSTRUMENT PANEL SUB-ASSY LOWER
(See page 71-12)

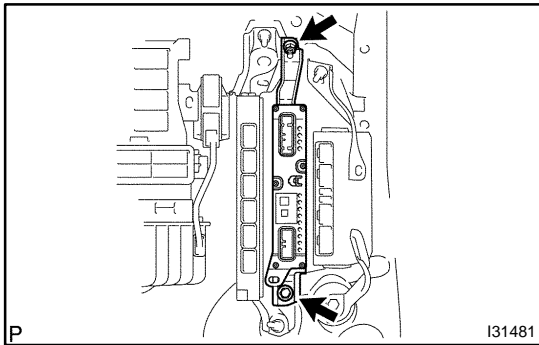

6. REMOVE STEREO COMPONENT AMPLIFIER ASSY
 - (a) Disconnect the connectors.
 - (b) Remove the 2 nuts and stereo component amplifier assy.

ANTENNA CORD SUB-ASSY REPLACEMENT

HINT:

COMPONENTS: See page 67-1

1. REMOVE FRONT DOOR SCUFF PLATE LH
(See page 71-12)
2. REMOVE FRONT DOOR SCUFF PLATE RH
(See page 71-12)
3. REMOVE COWL SIDE TRIM SUB-ASSY LH
(See page 71-12)
4. REMOVE COWL SIDE TRIM SUB-ASSY RH
(See page 71-12)
5. REMOVE INSTRUMENT PANEL COIN BOX SUB-ASSY
(See page 71-12)
6. REMOVE INSTRUMENT PANEL SUB-ASSY UPPER
(See page 71-12)
7. REMOVE INSTRUMENT PNL INSERT SUB-ASSY LWR LH (TMMK MADE)
(See page 71-12)
8. REMOVE AIR CONDITIONER CONTROL ASSEMBLY(See page 71-12)
9. REMOVE INSTRUMENT CLUSTER FINISH PANEL SUB-ASSY CENTER
(See page 71-12)
10. REMOVE INSTRUMENT PANEL UNDER COVER SUB-ASSY NO.1
(See page 71-12)
11. REMOVE GLOVE COMPARTMENT DOOR PAD
(See page 71-12)
12. REMOVE INSTRUMENT PANEL SUB-ASSY LOWER
(See page 71-12)
13. REMOVE FLOOR SHIFT SHIFT LEVER KNOB SUB-ASSY (M/T TRANSAXLE)
(See page 71-12)
14. REMOVE CONSOLE PANEL UPPER REAR
(See page 71-12)
15. REMOVE CONSOLE BOX CARPET
16. REMOVE RR CONSOLE BOX
(See page 71-12)
17. REMOVE INSTRUMENT PANEL CUP HOLDER TRAY (W/O ASHTRAY)
(See page 71-12)
18. REMOVE INSTRUMENT PANEL ASH RECEPTACLE ASSY (W/ ASHTRAY)
(See page 71-12)
19. REMOVE CONSOLE PANEL UPPER
(See page 71-12)
20. REMOVE CONSOLE BOX FRONT
(See page 71-12)
21. REMOVE INSTRUMENT PANEL FINISH PANEL LOWER CENTER
(See page 71-12)
22. REMOVE FRONT SEAT TRACK COVER LH REAR OUTER (TMC MADE)
(See page 72-7)
23. REMOVE FRONT SEAT TRACK COVER LH REAR INNER (TMC MADE)
(See page 72-7)

24. REMOVE FRONT SEAT TRACK COVER RH REAR OUTER (TMC MADE)
(See page 72-7)
25. REMOVE FRONT SEAT TRACK COVER RH REAR INNER (TMC MADE)
(See page 72-7)
26. REMOVE SEAT TRACK COVER LH(TMMK MADE)
(See page 72-14)
27. REMOVE SEAT TRACK BRACKET COVER INNER LH(TMMK MADE)
(See page 72-14)
28. REMOVE SEAT TRACK COVER RH(TMMK MADE)
(See page 72-14)
29. REMOVE SEAT TRACK BRACKET COVER INNER RH(TMMK MADE)
(See page 72-14)
30. REMOVE FRONT SEAT ASSY RH (POWER SEAT)(See page 72-7)
31. REMOVE FRONT SEAT ASSY RH (MANUAL SEAT)(See page 72-20)
32. REMOVE FRONT SEAT ASSY LH (POWER SEAT)(See page 72-7)
33. REMOVE FRONT SEAT ASSY LH (MANUAL SEAT)(See page 72-20)
34. REMOVE REAR SEAT CUSHION ASSY(See page 72-34 or 72-38)
35. REMOVE REAR SEAT BACK ASSY RH(See page 72-34 or 72-38)
36. REMOVE REAR SEAT BACK ASSY LH(See page 72-34 or 72-38)
37. REMOVE REAR SIDE SEAT BACK ASSY RH (TMC MADE)
(See page 72-34)
38. REMOVE REAR SIDE SEAT BACK ASSY LH (TMC MADE)
(See page 72-34)
39. REMOVE REAR SIDE SEAT BACK ASSY RH(TMMK MADE)
(See page 72-38)
40. REMOVE REAR SIDE SEAT BACK ASSY LH(TMMK MADE)
(See page 72-38)
41. REMOVE ROOF SIDE GARNISH INNER RH (W/O CURTAIN SHIELD AIR BAG)
(See page 76-20)
42. REMOVE ROOF SIDE GARNISH INNER LH (W/O CURTAIN SHIELD AIR BAG)
(See page 76-20)
43. REMOVE ROOF SIDE GARNISH INNER RH (W/ CURTAIN SHIELD AIR BAG)
(See page 76-20)
44. REMOVE ROOF SIDE GARNISH INNER LH (W/ CURTAIN SHIELD AIR BAG)
(See page 76-20)
45. REMOVE REAR SEAT SHOULDER BELT COVER RH
(See page 61-14)
46. REMOVE ROOM PARTITION BOARD ASSY(TMMK MADE)
(See page 61-17)
47. REMOVE PACKAGE TRAY TRIM PANEL ASSY(TMMK MADE)
(See page 61-17)
48. REMOVE PACKAGE TRAY TRIM PANEL ASSY (TMC MADE)
(See page 67-7)
49. REMOVE REAR SEAT 3 POINT TYPE BELT ASSY OUTER (TMC MADE)
(See page 61-14)
50. REMOVE REAR SEAT INNER W/CENTER BELT ASSY RH (TMC MADE)
(See page 61-14)
51. REMOVE REAR SEAT INNER W/CENTER BELT ASSY LH (TMC MADE)
(See page 61-14)

- 52. REMOVE REAR SEAT 3 POINT TYPE BELT ASSY OUTER(TMMK MADE)
(See page [61-17](#))
- 53. REMOVE REAR SEAT INNER W/CENTER BELT ASSY RH(TMMK MADE)
(See page [61-17](#))
- 54. REMOVE REAR SEAT INNER W/CENTER BELT ASSY LH(TMMK MADE)
(See page [61-17](#))
- 55. REMOVE ROOM PARTITION BOARD LH (TMC MADE)
(See page [67-7](#))
- 56. REMOVE ROOM PARTITION BOARD RH (TMC MADE)
(See page [67-7](#))
- 57. REMOVE AIR DUCT REAR NO.2
(See page [55-29](#))

58. REMOVE ANTENNA CORD SUB-ASSY

- (a) Remove the nut and 2 bolts.
- (b) Disconnect the connectors.
- (c) Remove the 12 clamps and antenna cord sub-assy.

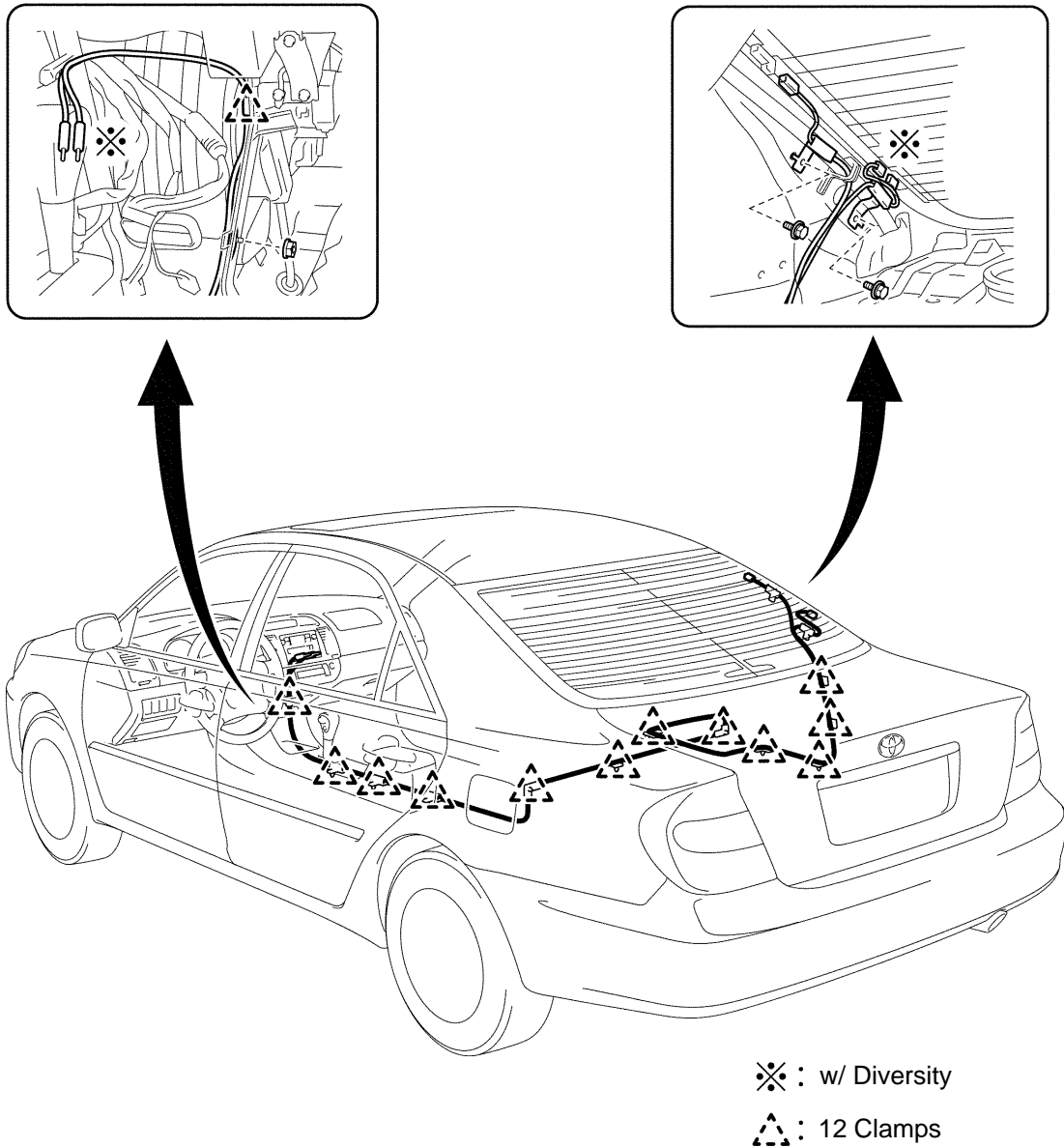

P

I31483

59. **INSTALL REAR SEAT INNER W/CENTER BELT ASSY RH (TMC MADE)**
 (See page 61-14)
60. **INSTALL REAR SEAT 3 POINT TYPE BELT ASSY OUTER (TMC MADE)**
 (See page 61-14)
61. **INSTALL REAR SEAT INNER W/CENTER BELT ASSY LH (TMC MADE)**
 (See page 61-14)
62. **INSTALL REAR SEAT INNER W/CENTER BELT ASSY RH(TMMK MADE)**
 (See page 61-17)
63. **INSTALL REAR SEAT 3 POINT TYPE BELT ASSY OUTER(TMMK MADE)**
 (See page 61-17)

- 64. INSTALL REAR SEAT INNER W/CENTER BELT ASSY LH(TMMK MADE)
(See page [61-17](#))
- 65. INSTALL REAR SIDE SEAT BACK ASSY LH (TMC MADE)
(See page [72-34](#))
- 66. INSTALL REAR SIDE SEAT BACK ASSY RH (TMC MADE)
(See page [72-34](#))
- 67. INSTALL REAR SIDE SEAT BACK ASSY LH(TMMK MADE)
(See page [72-38](#))
- 68. INSTALL REAR SIDE SEAT BACK ASSY RH(TMMK MADE)
(See page [72-38](#))
- 69. INSTALL REAR SEAT BACK ASSY RH(See page [72-34](#))
- 70. INSTALL REAR SEAT BACK ASSY LH(See page [72-34](#))
- 71. INSTALL FRONT SEAT ASSY LH (POWER SEAT)(See page [72-7](#))
- 72. INSTALL FRONT SEAT ASSY LH (MANUAL SEAT)(See page [72-20](#))
- 73. INSTALL FRONT SEAT ASSY RH (POWER SEAT)(See page [72-7](#))
- 74. INSTALL FRONT SEAT ASSY RH (MANUAL SEAT)(See page [72-20](#))

NAVIGATION ECU REPLACEMENT

67090-01

HINT:

COMPONENTS: See page 67-1 or 76-4

1. REMOVE LUGGAGE COMPARTMENT FLOOR MAT
2. REMOVE SPARE WHEEL COVER ASSY
3. REMOVE LUGGAGE COMPARTMENT SIDE COVER SUB-ASSY RH
4. REMOVE LUGGAGE COMPARTMENT TRIM HOOK NO.1
(See page 76-5)
5. REMOVE REAR FLOOR FINISH PLATE
(See page 76-5)
6. REMOVE LUGGAGE COMPARTMENT TRIM COVER INNER LH
(See page 76-5)

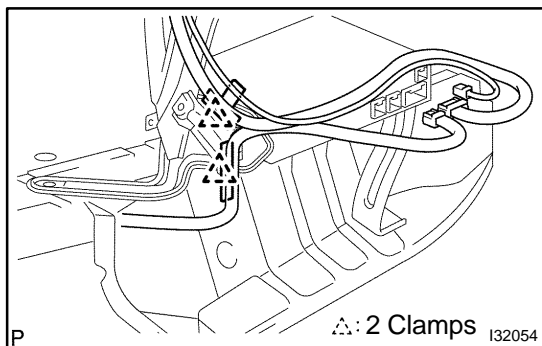

7. REMOVE NAVIGATION ECU

- (a) Disconnect the connectors and remove the 2 clamps.

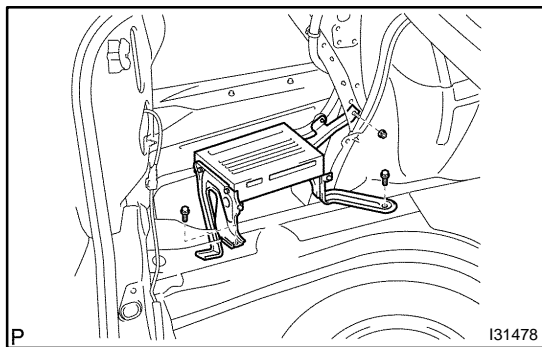

- (b) Remove the nut and 2 bolts, then remove the navigation ECU.

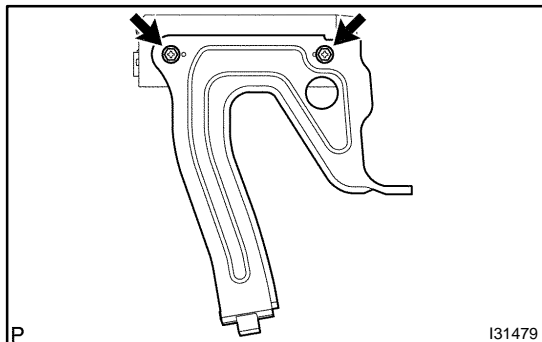

8. REMOVE DISC PLAYER BRACKET

- (a) Remove the 2 screws and disc player bracket.

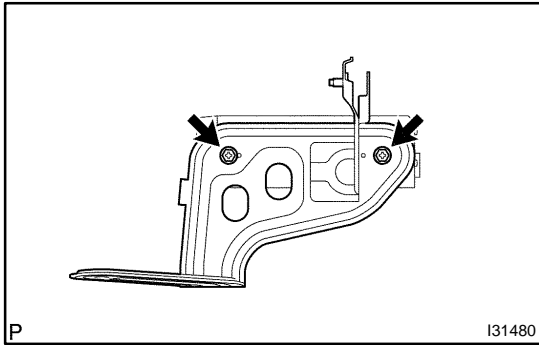
**9. REMOVE DISC PLAYER BRACKET NO.2**

- (a) Remove the 2 screws and disc player bracket No. 2.

NAVIGATION ANTENNA ASSY REPLACEMENT

67099-01

HINT:

COMPONENTS: See page 67-1

1. REMOVE LUGGAGE COMPARTMENT FLOOR MAT
2. REMOVE SPARE WHEEL COVER ASSY
3. REMOVE LUGGAGE COMPARTMENT TRIM HOOK NO.1
(See page 76-5)
4. REMOVE REAR FLOOR FINISH PLATE
(See page 76-5)
5. REMOVE LUGGAGE COMPARTMENT TRIM COVER INNER LH
(See page 76-5)
6. REMOVE REAR SEAT CUSHION ASSY(See page 72-34 or 72-38)
7. REMOVE REAR SEAT BACK ASSY RH(See page 72-34 or 72-38)
8. REMOVE REAR SEAT BACK ASSY LH(See page 72-34 or 72-38)
9. REMOVE REAR SIDE SEAT BACK ASSY RH(TMC MADE)
(See page 72-34)
10. REMOVE REAR SIDE SEAT BACK ASSY LH(TMC MADE)
(See page 72-34)
11. REMOVE REAR SIDE SEAT BACK ASSY RH(TMMK MADE)
(See page 72-38)
12. REMOVE REAR SIDE SEAT BACK ASSY LH(TMMK MADE)
(See page 72-38)
13. REMOVE ROOF SIDE GARNISH INNER RH(W/O CURTAIN SHIELD AIR BAG)
(See page 76-20)
14. REMOVE ROOF SIDE GARNISH INNER LH(W/O CURTAIN SHIELD AIR BAG)
(See page 76-20)
15. REMOVE ROOF SIDE GARNISH INNER RH(W/ CURTAIN SHIELD AIR BAG)
(See page 76-20)
16. REMOVE ROOF SIDE GARNISH INNER LH(W/ CURTAIN SHIELD AIR BAG)
(See page 76-20)
17. REMOVE REAR SEAT SHOULDER BELT COVER RH
(See page 61-14 or 61-17)
18. REMOVE ROOM PARTITION BOARD ASSY(TMMK MADE)
(See page 61-17)
19. REMOVE PACKAGE TRAY TRIM PANEL ASSY(TMC MADE)
(See page 67-7)
20. REMOVE PACKAGE TRAY TRIM PANEL ASSY(TMMK MADE)
(See page 61-17)
21. REMOVE REAR SEAT 3 POINT TYPE BELT ASSY OUTER(TMC MADE)
(See page 61-14)
22. REMOVE REAR SEAT INNER W/CENTER BELT ASSY RH(TMC MADE)
(See page 61-14)
23. REMOVE REAR SEAT INNER W/CENTER BELT ASSY LH(TMC MADE)
(See page 61-14)

- 24. REMOVE REAR SEAT 3 POINT TYPE BELT ASSY OUTER(TMMK MADE)
(See page 61-17)
- 25. REMOVE REAR SEAT INNER W/CENTER BELT ASSY RH(TMMK MADE)
(See page 61-17)
- 26. REMOVE REAR SEAT INNER W/CENTER BELT ASSY LH(TMMK MADE)
(See page 61-17)
- 27. REMOVE ROOM PARTITION BOARD LH(TMC MADE)
(See page 67-7)
- 28. REMOVE ROOM PARTITION BOARD RH(TMC MADE)
(See page 67-7)

29. REMOVE NAVIGATION ANTENNA ASSY

- (a) Disconnect the connector.

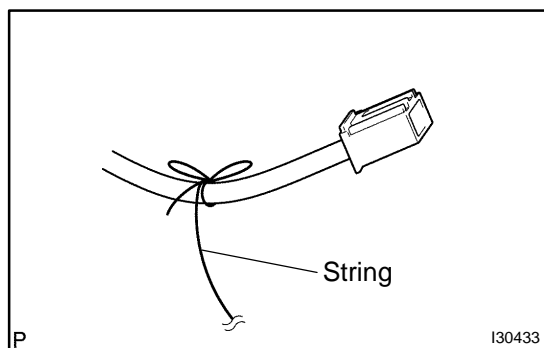

- (b) Tie the string at the tip of the cable of the navigation antenna assy.

- (c) Remove the screw.
- (d) Remove the 2 clamps and navigation antenna assy.

NOTICE:

As the string is used at the time of installation, remain it putting through the luggage room and the room side.

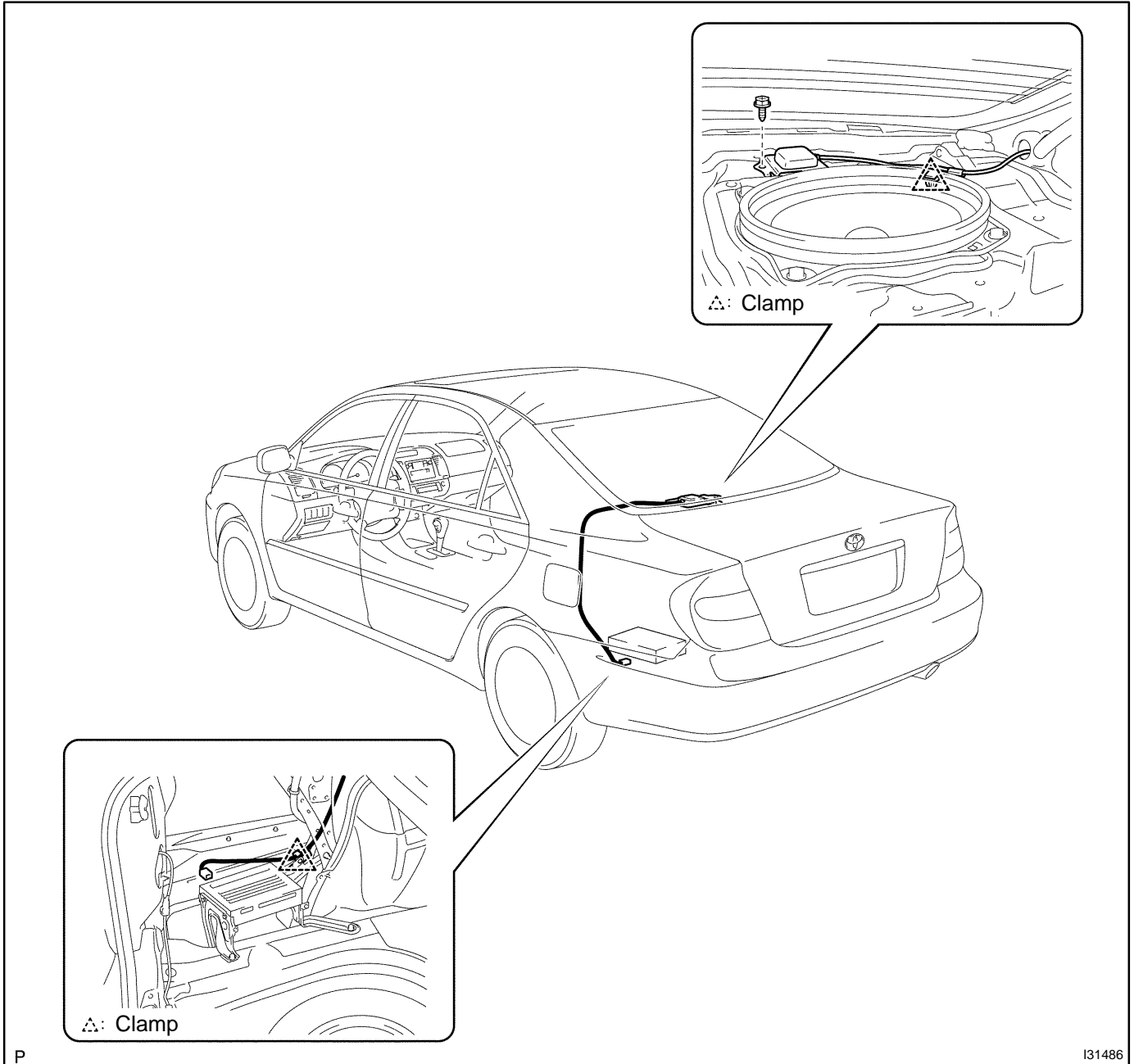
**30. INSTALL NAVIGATION ANTENNA ASSY**

- (a) Detach the string put through the luggage room and the room side from the connector and attach it with a new navigation antenna assy.
- (b) Using this string put the navigation antenna assy through the luggage room and the room side.

NOTICE:

To prevent the connector from being damaged, wrap protective tape around the tip of connector of the navigation antenna assy.

- (c) Install the navigation antenna assy with screw and 2 clamps.
- (d) Connect the connector.

31. INSTALL REAR SEAT INNER W/CENTER BELT ASSY RH(TMC MADE)
(See page [61-14](#))
32. INSTALL REAR SEAT 3 POINT TYPE BELT ASSY OUTER(TMC MADE)
(See page [61-14](#))
33. INSTALL REAR SEAT INNER W/CENTER BELT ASSY LH(TMC MADE)
(See page [61-14](#))
34. INSTALL REAR SEAT INNER W/CENTER BELT ASSY RH(TMMK MADE)
(See page [61-17](#))
35. INSTALL REAR SEAT 3 POINT TYPE BELT ASSY OUTER(TMMK MADE)
(See page [61-17](#))
36. INSTALL REAR SEAT INNER W/CENTER BELT ASSY LH(TMMK MADE)
(See page [61-17](#))
37. INSTALL REAR SIDE SEAT BACK ASSY LH(TMC MADE)
(See page [72-34](#))
38. INSTALL REAR SIDE SEAT BACK ASSY RH(TMC MADE)
(See page [72-34](#))
39. INSTALL REAR SIDE SEAT BACK ASSY LH(TMMK MADE)
(See page [72-38](#))
40. INSTALL REAR SIDE SEAT BACK ASSY RH(TMMK MADE)
(See page [72-38](#))
41. INSTALL REAR SEAT BACK ASSY RH(See page [72-34](#) or [72-38](#))
42. INSTALL REAR SEAT BACK ASSY LH(See page [72-34](#) or [72-38](#))

CIGARETTE LIGHTER ASSY REPLACEMENT

67096-01

HINT:

COMPONENTS: See page 67-1

1. REMOVE INSTRUMENT PANEL ASH RECEPTACLE ASSY (See page 71-12)

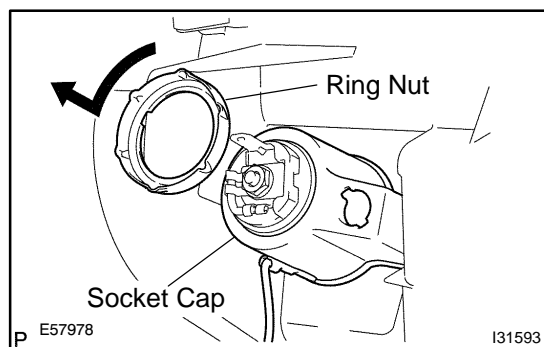

2. REMOVE CIGARETTE LIGHTER ASSY

- (a) Rotate the ring nut counterclockwise to remove it.
- (b) Remove the cigarette lighter assy from the instrument panel ash receptacle assy.

3. INSTALL CIGARETTE LIGHTER ASSY

- (a) Properly position the socket at the cutout of the instrument panel ash receptacle assy and insert them.
- (b) Install the socket cap.
- (c) Rotate the ring nut clockwise from the backside.

POWER POINT SOCKET ASSY REPLACEMENT

67098-01

HINT:

COMPONENTS: See page 67-1

1. REMOVE FLOOR SHIFT SHIFT LEVER KNOB SUB-ASSY(M/T TRANSAXLE)
(See page 71-12)
2. REMOVE CONSOLE PANEL UPPER REAR
(See page 71-12)
3. REMOVE INSTRUMENT PANEL CUP HOLDER TRAY(W/O ASHTRAY)
(See page 71-12)
4. REMOVE INSTRUMENT PANEL ASH RECEPTACLE ASSY(W/ ASHTRAY)
(See page 71-12)
5. REMOVE CONSOLE PANEL UPPER
(See page 71-12)

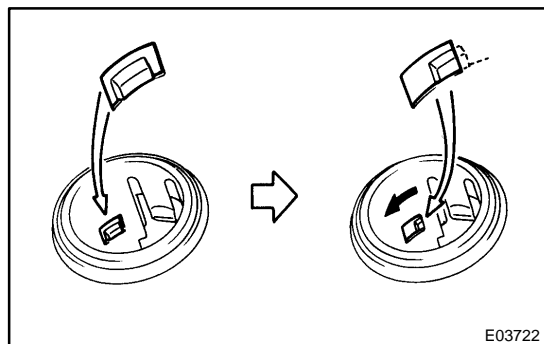

E03722

6. REMOVE POWER POINT SOCKET ASSY

- (a) Turn the socket in the circumference direction as shown the illustration, disengage the claw between the socket and the power pint socket cover, and push out the socket to the room side.

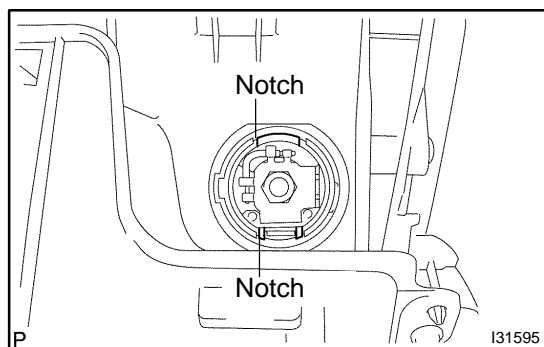

I31595

- (b) Align the socket with the notch on the power point socket cover, remove the power point socket assy to the room side.

7. INSTALL POWER POINT SOCKET ASSY

- (a) Align the socket with the notch on the power point socket cover, push the power point socket assy into as hard as possible and install it.

POWER POINT SOCKET ASSY RR REPLACEMENT

67095-01

HINT:

COMPONENTS: See page 67-1

1. REMOVE FLOOR SHIFT SHIFT LEVER KNOB SUB-ASSY(M/T TRANSAXLE)
(See page 71-12)
2. REMOVE CONSOLE PANEL UPPER REAR
(See page 71-12)
3. REMOVE CONSOLE BOX CARPET
(See page 71-12)
4. REMOVE RR CONSOLE BOX(See page 71-12)

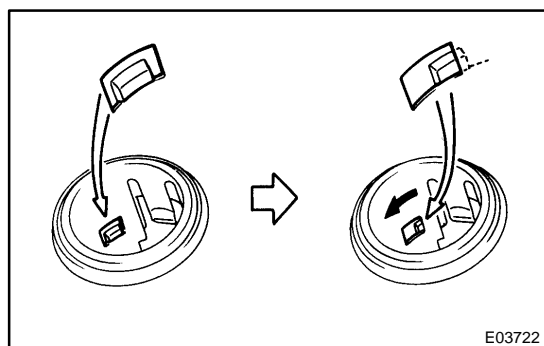

5. REMOVE POWER POINT SOCKET ASSY RR

- (a) Remove the clamp.
- (b) Turn the socket in the circumference direction as shown the illustration, disengage the claw between the socket and the power outlet socket cover RR, and push out the socket to the room side.

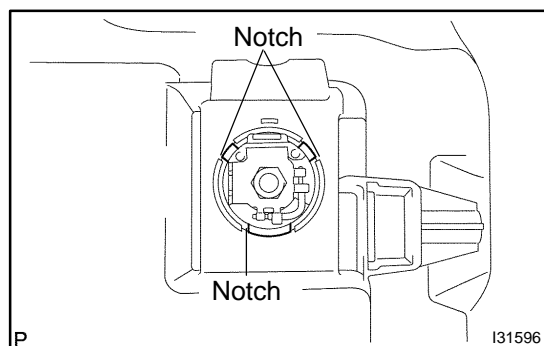

- (c) Align the socket with the notch on the power outlet socket cover RR, remove the power point socket assy RR to the room side.

6. INSTALL POWER POINT SOCKET ASSY RR

- (a) Align the socket with the notch on the power outlet socket cover RR, push the power point socket assy RR into as hard as possible and install it.

WINDOW GLASS (ANTENNA WIRE) REPAIR

67094-01

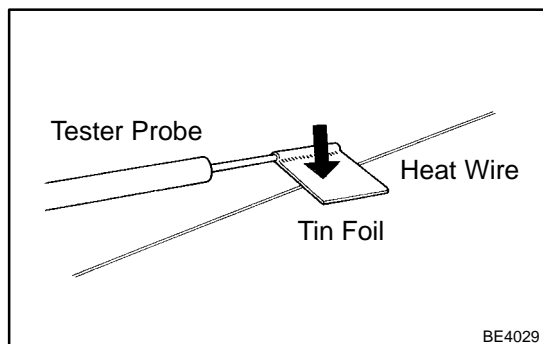

1. INSPECT WINDOW GLASS (ANTENNA WIRE)

NOTICE:

When cleaning the glass, use a soft, dry cloth, and wiper the glass in the direction of the wire. Take care not to damage the wires. Do not use detergents or glass cleaners with abrasive ingredients. When measuring voltage, wind a piece of tin foil around the top of the negative probe and press the foil against the wire with your finger, as shown in the illustration.

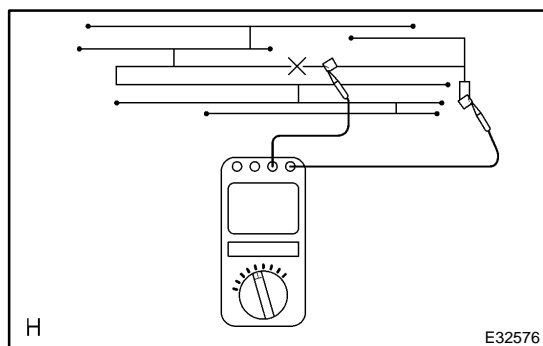

- (a) Inspect the continuity, at the center of each antenna wire, as shown in the illustration.

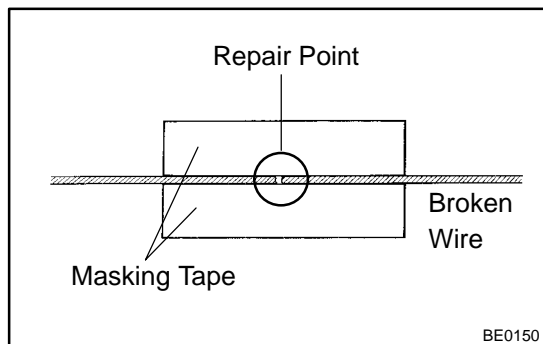

2. REPAIR WINDOW GLASS (ANTENNA WIRE)

- (a) Clean the broken wire tips with a grease, wax and silicone remover.
 (b) Place the masking tape along both sides of the wire to be repaired.
 (c) Thoroughly mix the repair agent (Dupont paste No. 4817).

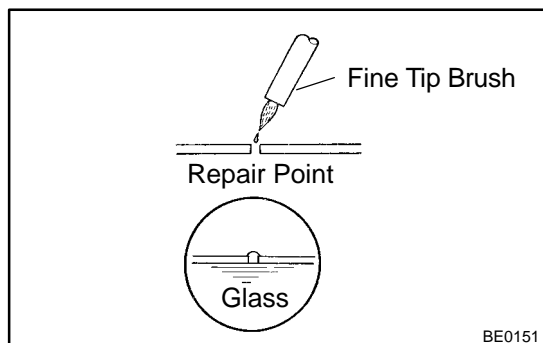

- (d) Using a fine tip brush, apply a small amount to the wire.
 (e) After a few minutes, remove the masking tape.
 (f) Do not repair the defogger wire for at least 24 hours.