

EXHAUST PIPE

COMPONENTS

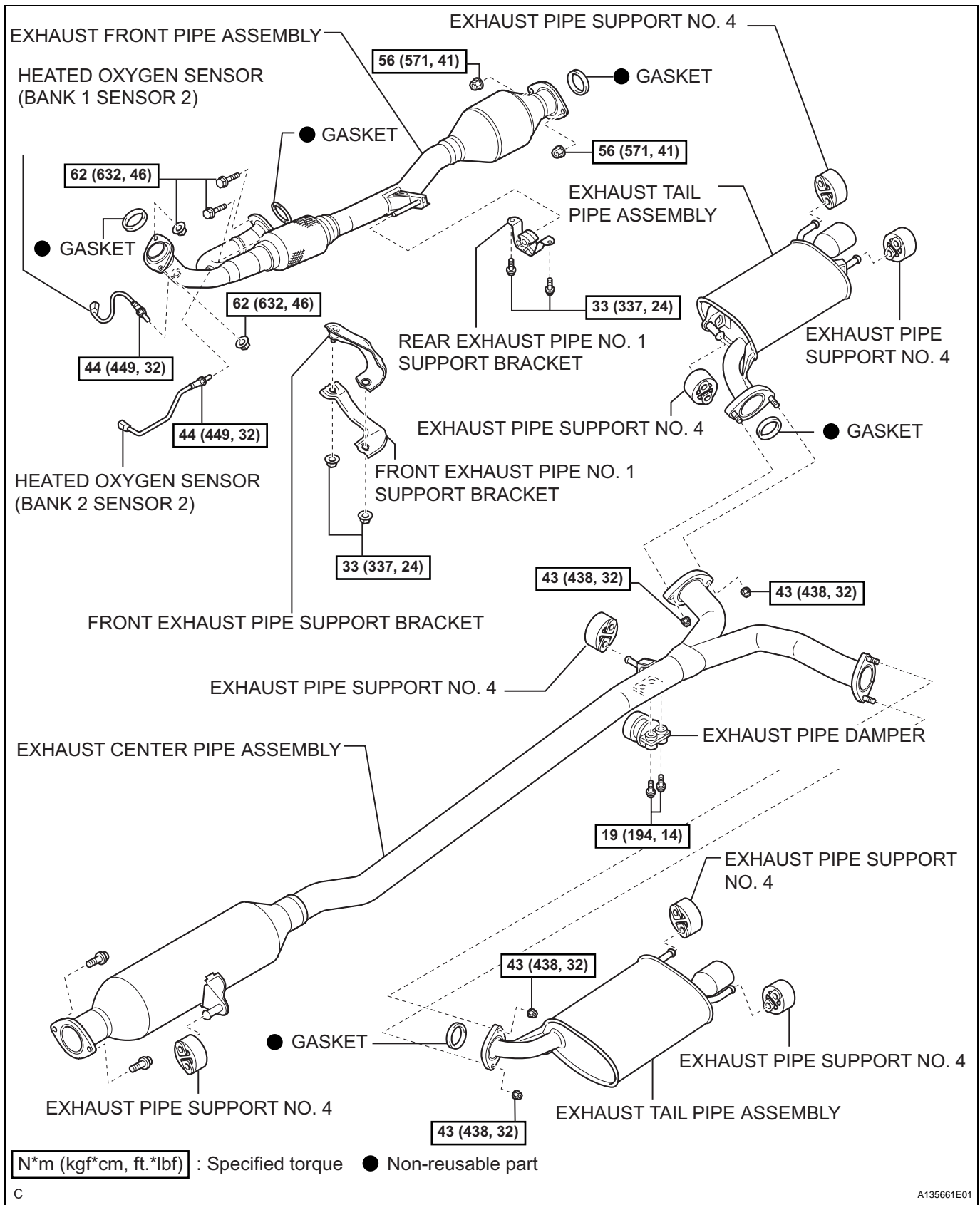

EX

REMOVAL

1. REMOVE EXHAUST TAIL PIPE ASSEMBLY

- (a) Remove the 4 nuts and 2 exhaust tail pipes.

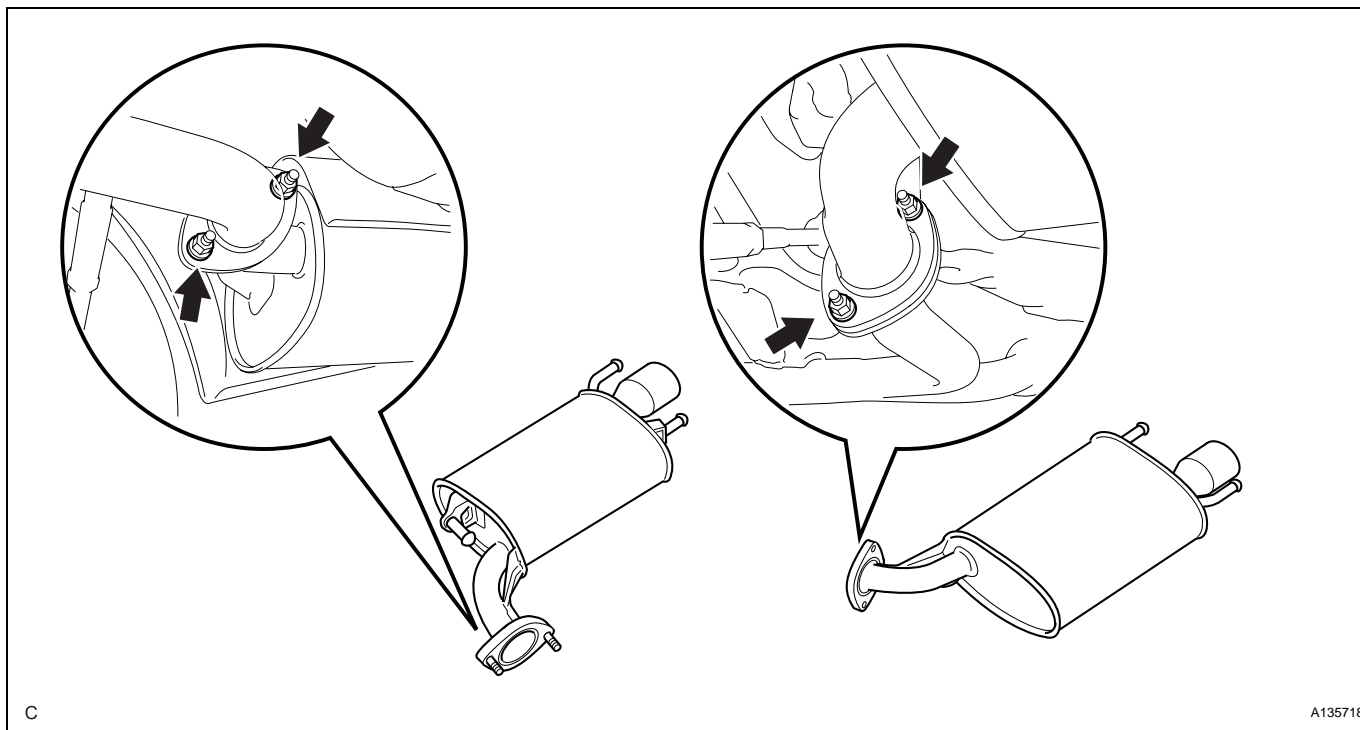

- (b) Remove the 2 gaskets from the exhaust center pipe assembly.

2. REMOVE EXHAUST CENTER PIPE ASSEMBLY

- (a) Remove the 2 bolts, 2 nuts and exhaust center pipe assembly.

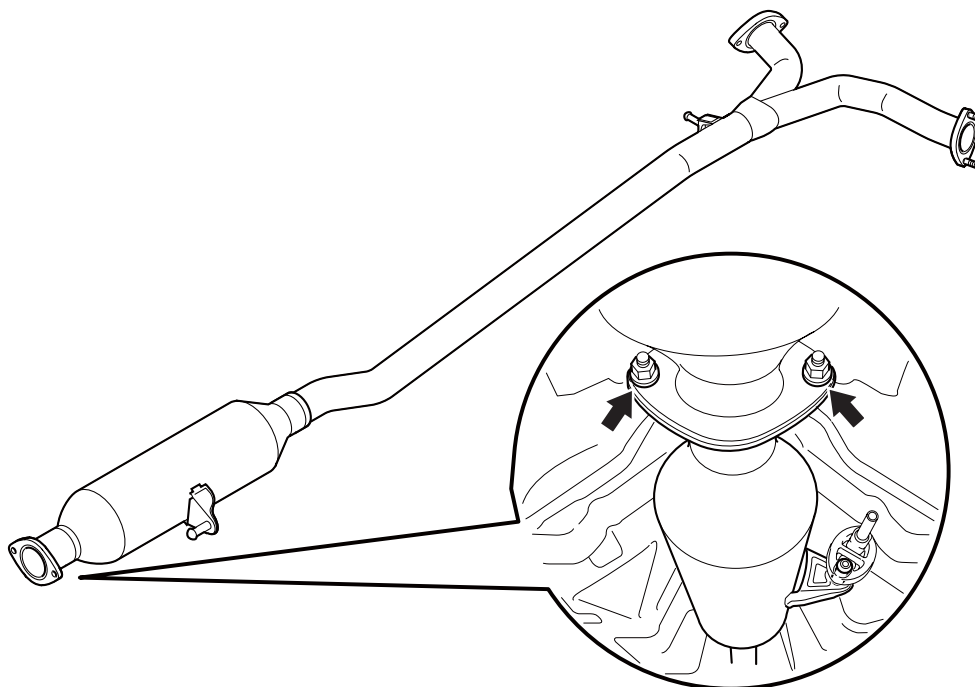

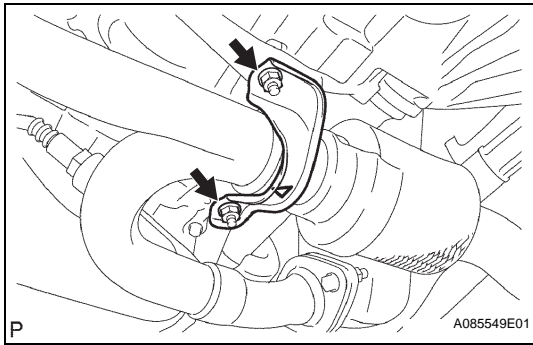

(b) Remove the gasket from the exhaust pipe assembly.

3. REMOVE FRONT EXHAUST PIPE NO. 1 SUPPORT BRACKET

(a) Remove the 2 nuts and front support brackets.

4. REMOVE EXHAUST FRONT PIPE ASSEMBLY

(a) Disconnect the 2 heated oxygen sensor (bank 1, 2 sensor 2) connectors.

(b) Remove the 2 nuts from the exhaust front pipe (left bank exhaust manifold side).

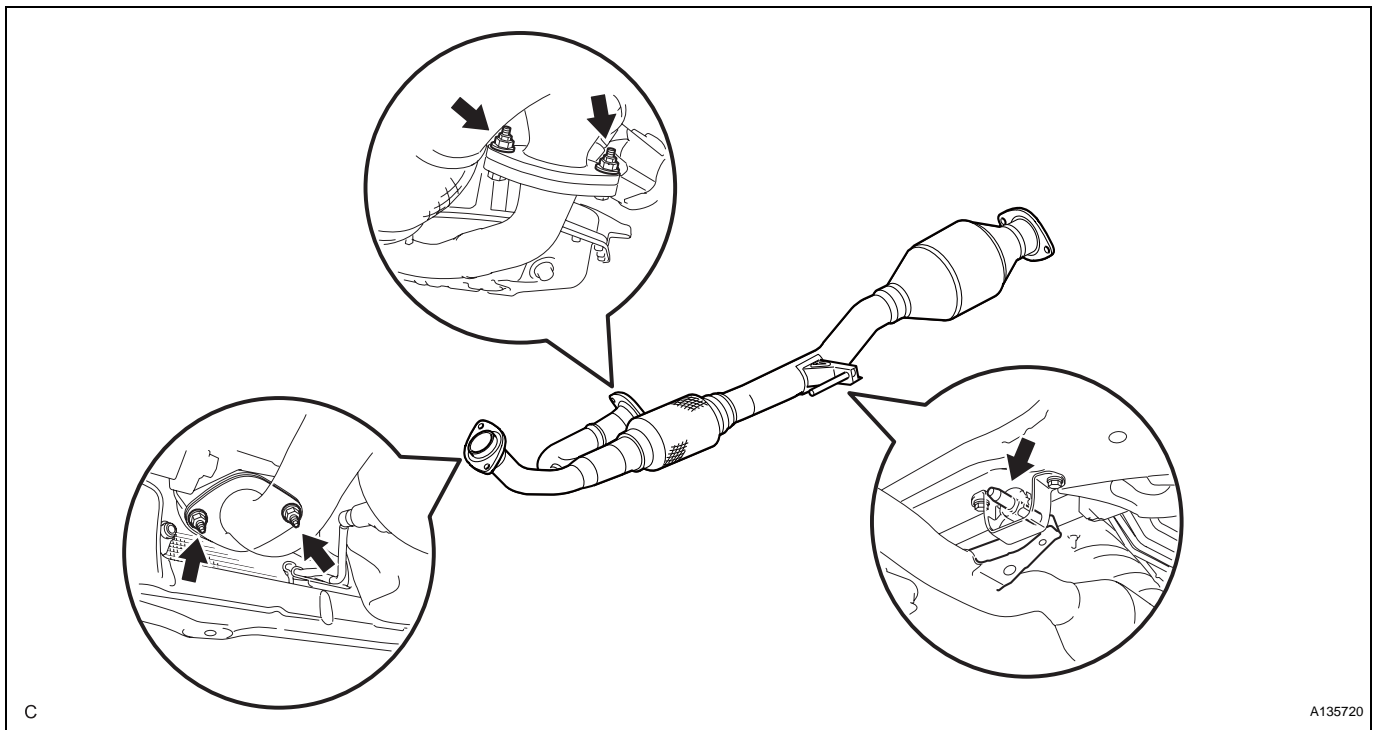

(c) Remove the 2 nuts from the exhaust front pipe (right bank exhaust pipe manifold side).

(d) Remove the exhaust front pipe.

(e) Remove the 2 gaskets from the exhaust front pipe.

5. REMOVE HEATED OXYGEN SENSOR (See page [EC-21](#))

6. REMOVE REAR EXHAUST PIPE NO. 1 SUPPORT BRACKET

(a) Remove the 2 bolts and rear support bracket.

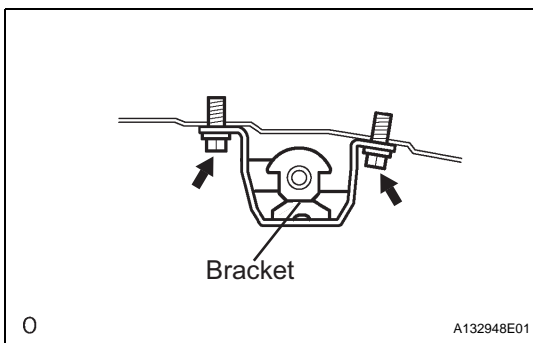

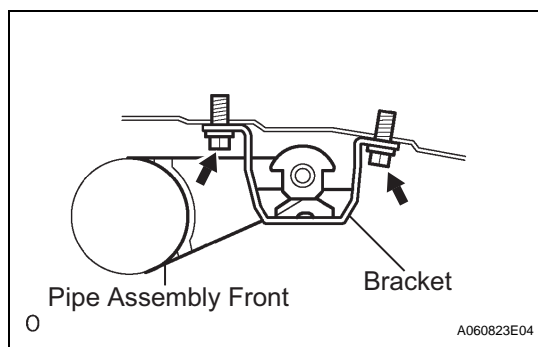

INSTALLATION

1. INSTALL REAR EXHAUST PIPE NO. 1 SUPPORT BRACKET

- (a) Install the rear support bracket with the 2 bolts.

Torque: 33 N*m (337 kgf*cm, 24 ft.*lbf)

NOTICE:

Be sure to install the bracket in the correct direction.

2. INSTALL HEATED OXYGEN SENSOR (See page [EC-21](#))

3. INSTALL EXHAUST FRONT PIPE ASSEMBLY

- (a) Install 2 new gaskets to the exhaust front pipe.
 (b) Install the exhaust front pipe to the exhaust manifolds with the 4 nuts.

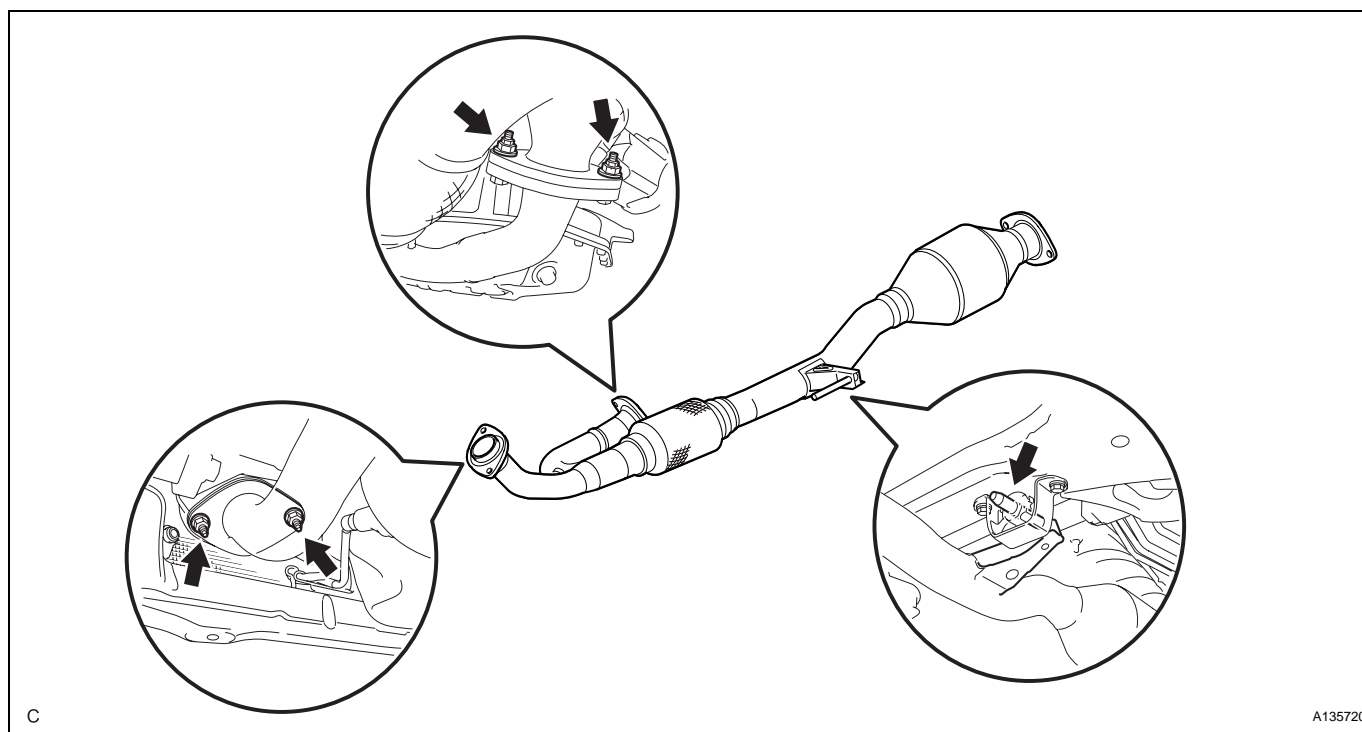

Torque: 62 N*m (632 kgf*cm, 46 ft.*lbf)

4. INSTALL FRONT EXHAUST PIPE NO. 1 SUPPORT BRACKET

- (a) Install the front support brackets with the 2 nuts.

Torque: 33 N*m (337 kgf*cm, 24 ft.*lbf)

NOTICE:

Be sure to install the support brackets in the correct direction.

5. INSTALL EXHAUST CENTER PIPE ASSEMBLY

- (a) Install a new gasket to the exhaust center pipe assembly.

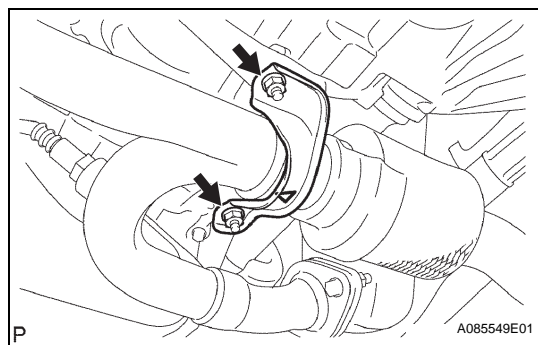

- (b) Install the exhaust center pipe to the exhaust front pipe with the 2 nuts and 2 bolts.

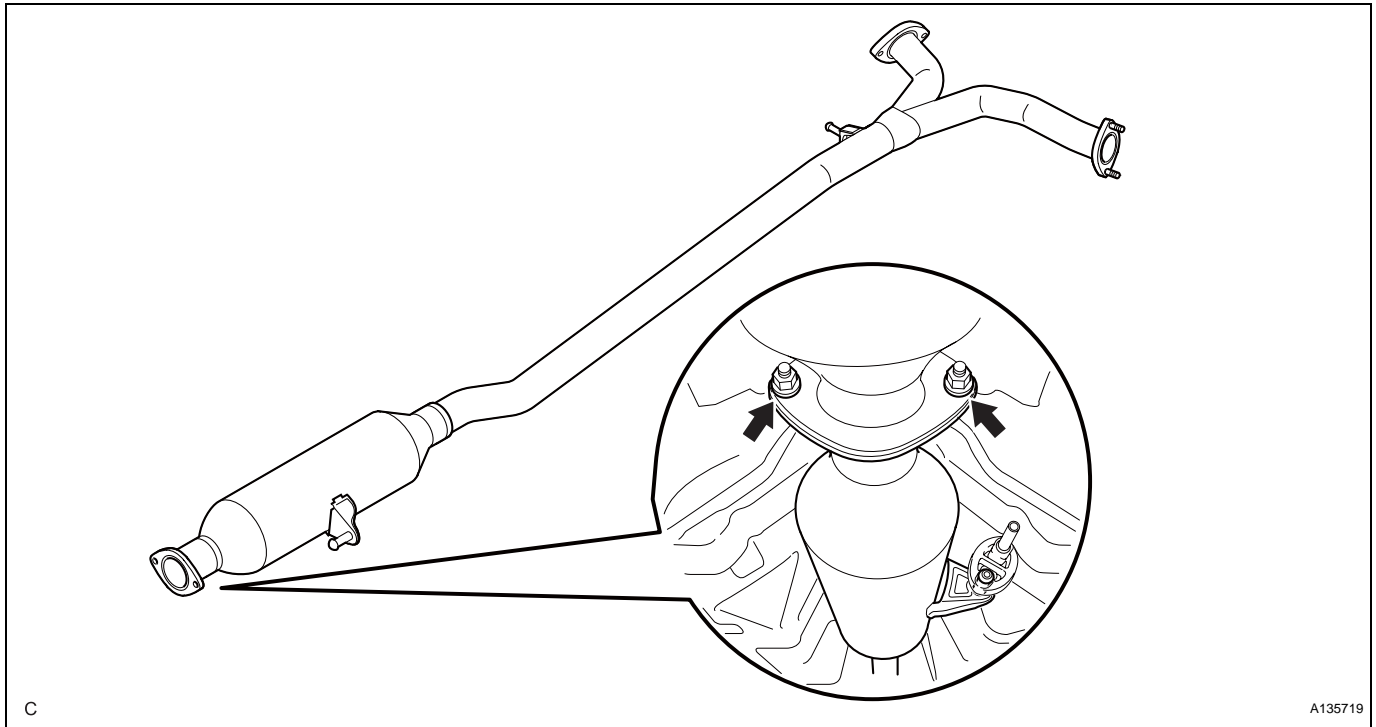

Torque: 56 N*m (571 kgf*cm, 41 ft.*lbf)

6. INSTALL EXHAUST TAIL PIPE ASSEMBLY

- (a) Install 2 new gaskets to the exhaust tail pipes.
(b) Install the 2 exhaust tail pipes with the 4 nuts.

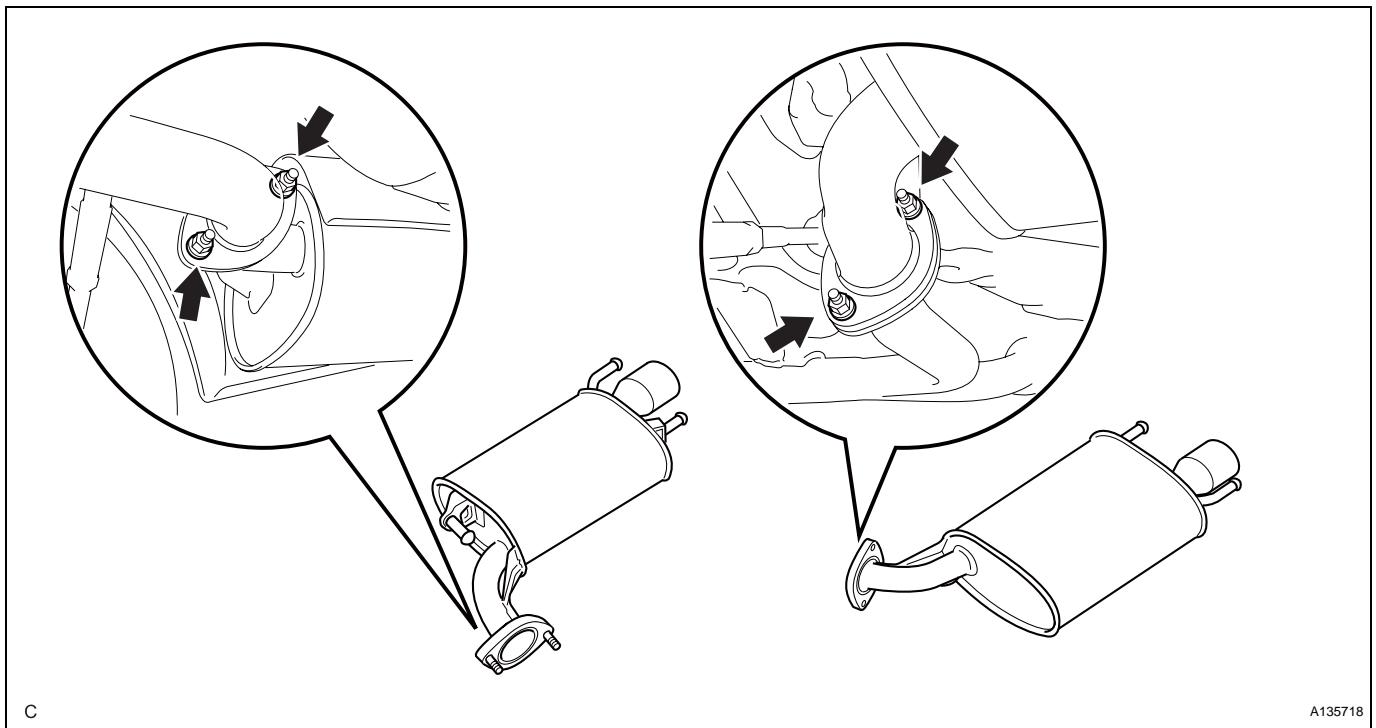

Torque: 43 N*m (438 kgf*cm, 32 ft.*lbf)

7. CHECK FOR EXHAUST GAS LEAKS

If gas is leaking, tighten the areas necessary to stop the leak. Replace the damaged parts as necessary.